



# UB-S-90 ◀ 059 cm ▶



## Safe and approved storage of flammable hazardous substances in working areas

### Function / construction:

- **robust construction and longevity:** body made of powder-coated sheet steel
- **user-friendly:** drawer remains open in any position, interior of drawer completely visible – access to all containers
- **safe:** drawer fitted with earthing wire incl. clamp as standard, seal welded sump, drawers are self-closing in the event of fire
- **no unauthorised use:** drawer lockable with cylinder lock and locking state indicator (red/green)
- **mobile:** castors with plinth (optionally available), easy moving of the cabinet
- **ventilation:** integrated air ducts ready for connection (DN 50) to a technical exhaust system

### Available equipment

- perforated insert useable as storage area
- plenty of space for small containers, optimal utilisation of the inside space when storing small containers

### Safety storage underbench cabinet

#### UB-S-90 model UB90.060.059.S

in Light grey (RAL 7035), interior equipment with 1 x drawer (sheet steel powder-coated), 1 x perforated insert (stainless steel)

Order No. 30472-001-30474 4



### Second level drawer

Plenty of space for small containers, optimal utilisation of the inside space when storing small containers



### Recirculating air filter system

Avoid complex wall breakthroughs and expensive extraction piping.

Especially designed for the lower pressure conditions and volume flows of underbench cabinets.

Further information from page 395

Order No. 27144 2

(housing unit optional)



### Technical data

	UB90.060.059.S	UB90.060.059.050.S
External dimensions W x D x H	mm 593 x 574 x 600	593 x 502 x 600
Internal dimensions W x D x H	mm 470 x 452 x 502	470 x 382 x 502
Weight without interior equip.	kg 120	110
Extraction air	DN 50	50
Air change <b>10 times</b>	m <sup>3</sup> /h 1	1
Diff. pressure (air change <b>10 times</b> )	Pa 1	1
Diff. pressure (air change <b>10 times EKS/AK4</b> )	Pa 1	1
Maximum load	kg 300	300
Distributed load	kg/m <sup>2</sup> 450.00	460.00

### Usable storage heights

UB90.060.059(.050).S  
1 mm 460\*\*

UB90.060.059.S  
2 mm 230\*\*\*

\*\* without perforated insert  
\*\*\* with second level drawer

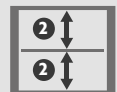
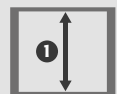

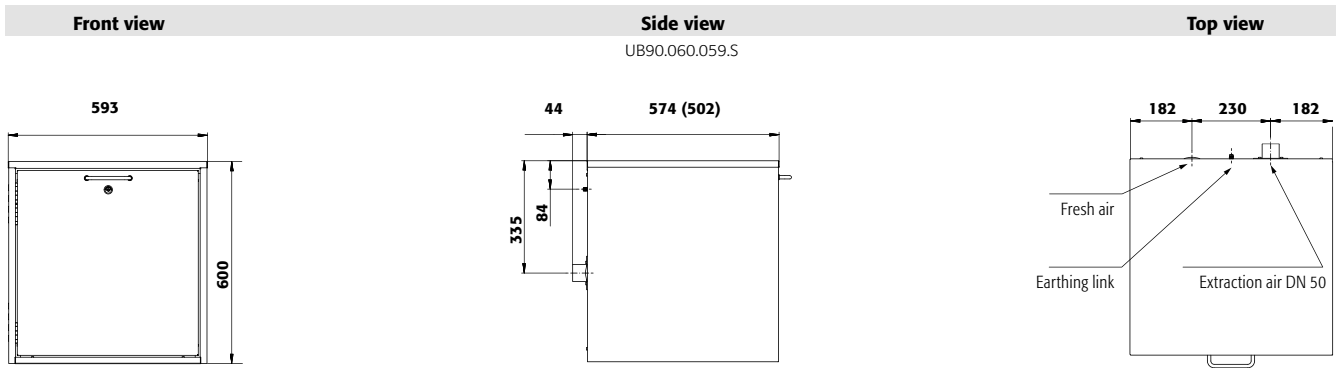

UB-LINE

**Order example - how to order correctly**



Model	Information / equipment		Order No.
UB90.060.059.S	without Interior equipment, with drawer	11.5	30472
UB90.060.059.050.S	without interior equipment, with drawer	10	30473

Body colour	Door colour	Order No.
Light grey RAL 7035	Light grey RAL 7035	001 <sup>4</sup>

Interior equipment packages (can only be ordered in combination with the cabinet)	Material	Order No.
<b>Depth 574 (mm)</b> 1x drawer (V=11.0L), 1x perforated insert	sheet steel powder-coated, stainless steel	30474 <sup>2</sup>
1x drawer (V=11.0L), 1x perforated insert, 1x second level drawer (V=3.0L)	sheet steel powder-coated, stainless steel, sheet steel powder-coated RAL 7035	30475 <sup>2</sup>

Interior equipment	Material	W x D x H (mm)	1) <sup>1</sup>	2) <sup>2</sup>	3) <sup>3</sup>	Order No.
<b>Depth 574 mm</b> perforated insert	stainless steel	420 x 439 x 9	75.00			9975 <sup>2</sup>
second level drawer	sheet steel powder-coated RAL 7035	442 x 418 x 45*	25.00	3.00	2.73	30476 <sup>2</sup>
second level drawer	stainless steel	430 x 418 x 45*	25.00	3.50	3.18	30477 <sup>2</sup>
sump inliner, for second level drawer (1 pc, recom. 2 pcs)	PP white	420 x 199 x 20*				10905 <sup>2</sup>
sump inliner	PP grey	353 x 406 x 88*				9706 <sup>2</sup>
anti-slip rubber mat	black	420 x 438 x 1				8698 <sup>2</sup>
drawer, additional charge for sump made of stainless steel	stainless steel	425 x 444 x 80				30733 <sup>2</sup>

Interior equipment	Material	W x D x H (mm)	1) <sup>1</sup>	2) <sup>2</sup>	3) <sup>3</sup>	Order No.
<b>Depth 502 mm</b> perforated insert, for cabinet/compartment width 59 cm	stainless steel	417 x 364 x 9	75.00			18922 <sup>2</sup>

Interior equipment	Material	W x D x H (mm)	Order No.
<b>All models</b> pipe lead-through	sheet steel powder-coated RAL 7035	182 x 104 x 48	30035 <sup>2</sup>
bottle rack, for 8 bottles with Ø 90 mm	sheet steel powder-coated RAL 7035	220 x 440 x 30	7604 <sup>2</sup>
bottle rack, for 15 bottles with Ø 70 mm	sheet steel powder-coated RAL 7035	220 x 440 x 30	7603 <sup>2</sup>
bottle rack, for 32 bottles with Ø 40 mm	sheet steel powder-coated RAL 7035	220 x 440 x 30	7602 <sup>2</sup>
castors with plinth, height = 30 mm	sheet steel powder-coated RAL 7035		30478 <sup>2</sup>

Accessories	Order No.
extraction module with exhaust air monitoring for wall mounting, for underbench cabinets	24315 <sup>2</sup>
recirculating air filter system with exhaust air monitoring, for underbench cabinets	27144 <sup>2</sup>
adaptor, as separate housing unit for lateral mounting	26885 <sup>2</sup>

\* usable storage space W x D (mm)  
1) load capacity (kg), 2) retention capacity (ltr), 3) maximum container volume in the cabinet (ltr)



UB-S-90 ◀ 059 cm ▶



**Safe and approved storage of flammable hazardous substances in working areas**

**Function / construction:**

- **robust construction and longevity:** body made of powder-coated sheet steel
- **user-friendly:** drawer remains open in any position, interior of drawer completely visible – access to all containers
- **safe:** drawer fitted with earthing wire incl. clamp as standard, seal welded sump, drawers are self-closing in the event of fire
- **no unauthorised use:** drawer lockable with cylinder lock and locking state indicator (red/green)
- **mobile:** castors with plinth (optionally available), easy moving of the cabinet
- **ventilation:** integrated air ducts ready for connection (DN 50) to a technical exhaust system

**Available equipment**

- perforated insert useable as storage area
- plenty of space for small containers, optimal utilisation of the inside space when storing small containers

**Safety storage underbench cabinet**

**UB-S-90 model UB90.080.059.060.S**

in Light grey (RAL 7035), interior equipment with 1 x drawer (sheet steel powder-coated), 1 x perforated insert (stainless steel)

**Order No. 32658-001-30474**



**Special height of 800 mm**

Optimal utilisation of the inside space – it's possible to store 2.5 litre bottles on two levels.



**Extraction module for wall mounting**

Especially designed for the lower pressure conditions and volume flows of under-bench cabinets.

Further information and products from page 397

**Order No. 24315**



**Technical data**

**UB90.080.059.060.S**

External dimensions W x D x H	mm	593 x 600 x 800
Internal dimensions W x D x H	mm	470 x 482 x 702
Weight without interior equip.	kg	143
Extraction air	DN	50
Air change <b>10 times</b>	m <sup>3</sup> /h	2
Diff. pressure (air change <b>10 times</b> )	Pa	1
Diff. pressure (air change <b>10 times EK5/AK4</b> )	Pa	1
Maximum load	kg	300
Distributed load	kg/m <sup>2</sup>	467.00

**Usable storage heights**

**UB90.080.059.060.S**

- ① mm 665\*\*
- ② mm 330\*\*\*

\*\* without perforated insert  
\*\*\* with second level drawer

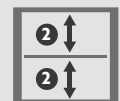
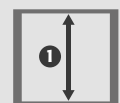



Front view

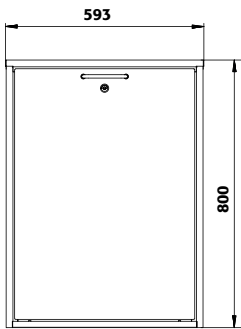

Side view

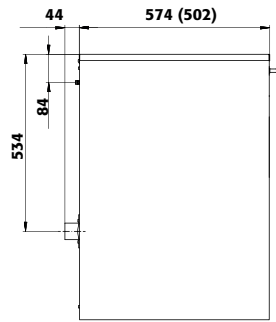

Top view

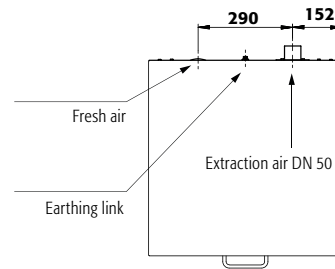

UB-LINE

Order example - how to order correctly



	<b>Model</b> UB90.080.059.060.S	<b>Information / equipment</b> without interior equipment, with drawer		21.5	<b>Order No.</b> 32658
	<b>Body colour</b> Light grey RAL 7035	<b>Door colour</b> Light grey RAL 7035			<b>Order No.</b> 001
	<b>Interior equipment packages (can only be ordered in combination with the cabinet)</b>		<b>Material</b>		<b>Order No.</b>
	1x drawer (V=11.0L), 1x perforated insert		sheet steel powder-coated, stainless steel		30474
	1x drawer (V=11.0L), 1x perforated insert, 1x second level drawer (V=3.0L)		sheet steel powder-coated, stainless steel, sheet steel powder-coated RAL 7035		30475
	<b>Interior equipment</b>	<b>Material</b>	<b>W x D x H (mm)</b>	1)  2)  3)	<b>Order No.</b>
	perforated insert	stainless steel	420 x 439 x 9	75.00	9975
	second level drawer	sheet steel powder-coated RAL 7035	442 x 418 x 45*	25.00 3.00 2.73	30476
	second level drawer	stainless steel	430 x 418 x 45*	25.00 3.50 3.18	30477
	sump inliner, for second level drawer (1 pc, recom. 2 pcs)	PP white	420 x 199 x 20*		10905
	sump inliner	PP grey	353 x 406 x 88*		9706
	anti-slip rubber mat	black	420 x 438 x 1		8698
	pipe lead-through	sheet steel powder-coated RAL 7035	182 x 104 x 48		30035
	bottle rack, for 8 bottles with Ø 90 mm	sheet steel powder-coated RAL 7035	220 x 440 x 30		7604
	bottle rack, for 15 bottles with Ø 70 mm	sheet steel powder-coated RAL 7035	220 x 440 x 30		7603
	bottle rack, for 32 bottles with Ø 40 mm	sheet steel powder-coated RAL 7035	220 x 440 x 30		7602
	castors with plinth, height = 30 mm	sheet steel powder-coated RAL 7035			30478
	document holder, DIN A5	polystyrene			30793
	<b>Accessories</b>				<b>Order No.</b>
	extraction module with exhaust air monitoring for wall mounting, for underbench cabinets				24315

\* usable storage space W x D (mm)  
1) load capacity (kg), 2) retention capacity (ltr), 3) maximum container volume in the cabinet (ltr)





# WolfLabs

**Pricing on any accessories shown can be found by keying the part number into the search box on our website.**

The specifications listed in this brochure are subject to change by the manufacturer and therefore cannot be guaranteed to be correct. If there are aspects of the specification that must be guaranteed, please provide these to our sales team so that details can be confirmed.

**[www.wolflabs.co.uk](http://www.wolflabs.co.uk)**

**Tel : 01759 301142**

**Fax : 01759 301143**

**[sales@wolflabs.co.uk](mailto:sales@wolflabs.co.uk)**

Please contact us if this literature doesn't answer all your questions.